

GEYSER

P5



User Manual



Edition Notes

The Geyser P5 User Manual includes a description, safety precautions, installation, programming, operation, and maintenance instructions for the Geyser P5 as of the release date of this edition.

Trademarks

Chauvet, Chauvet DJ, the Chauvet logo, and Geyser are registered trademarks or trademarks of Chauvet & Sons, LLC (d/b/a Chauvet and Chauvet Lighting) in the United States and other countries. Other company and product names and logos referred to herein may be trademarks of their respective companies.

Copyright Notice

The works of authorship contained in this manual, including, but not limited to, all designs, text, and images are owned by Chauvet.

© **Copyright 2025 Chauvet & Sons, LLC. All rights reserved.**

Electronically published by Chauvet in the United States of America.

Manual Use

Chauvet authorizes its customers to download and print this manual for professional information purposes only. Chauvet expressly prohibits the usage, copy, storage, distribution, modification, or printing of this manual or its content for any other purpose without written consent from Chauvet.

Document Printing

For best results, print this document in color, on letter size paper (8.5 x 11 in), double-sided. If using A4 paper (210 x 297 mm), configure the printer to scale the content accordingly.

Intended Audience

Any person installing, operating, and/or maintaining this product should completely read through the guide that shipped with the product, as well as this manual, before installing, operating, or maintaining this product.

Disclaimer

Chauvet believes that the information contained in this manual is accurate in all respects. However, Chauvet assumes no responsibility and specifically disclaims any and all liability to any party for any loss, damage, or disruption caused by any errors or omissions in this document, whether such errors or omissions result from negligence, accident, or any other cause. Chauvet reserves the right to revise the content of this document without any obligation to notify any person or company of such revision; however, Chauvet has no obligation to make, and does not commit to make, any such revisions.

Document Revision

Go to www.chauvetdj.com for the latest version.

Revision	Date	Description
5	06/2025	Updated mounting instructions, maintenance, formatting.

TABLE OF CONTENTS

1. Before You Begin	1
What Is Included	1
Unpacking Instructions.....	1
Claims	1
Text Conventions	1
Symbols	1
Safety Notes.....	2
2. Introduction.....	3
Product Overview.....	3
Product Dimensions	3
3. Setup.....	4
AC Power	4
Fuse Replacement	4
Mounting	5
Orientation.....	5
Inverting the Tank	5
Rigging	6
4. Operation.....	7
Control Panel Operation.....	7
Menu Map	7
DMX Configuration.....	7
Starting Address.....	7
DMX Channel Assignments and Values	8
DMX Charts.....	8
Geyser Wireless Remote Configuration.....	9
Geyser Wireless Remote Control Overview.....	9
Manual Configuration	9
5. Maintenance.....	10
Product Maintenance	10
Fog Machine Maintenance.....	11
Storage.....	11
6. Technical Specifications.....	12
Contact Us.....	13
Warranty & Returns.....	13

1. Before You Begin

What Is Included

- Geyser P5
- Power cable
- Geyser wireless remote control and receiver
- Quick Reference Guide

Unpacking Instructions

Carefully unpack the product immediately and check the container to make sure all the parts are in the package and are in good condition.

Claims



If the box or the contents (the product and included accessories) appear damaged from shipping, or show signs of mishandling, notify the carrier immediately, not Chauvet. Failure to report damage to the carrier immediately may invalidate a claim. In addition, keep the box and contents for inspection.

For other issues, such as missing components or parts, damage not related to shipping, or concealed damage, file a claim with Chauvet within 7 days of delivery.

Text Conventions

Convention	Meaning
1–512	A range of values
50/60	A set of values of which only one can be chosen
Settings	A menu option not to be modified
<ENTER>	A key to be pressed on the product's control panel
ON	A value to be entered or selected

Symbols

Symbol	Meaning
	Critical installation, configuration, or operation information. Not following these instructions may make the product not work, cause damage to the product, or cause harm to the operator.
	Important installation or configuration information. The product may not function correctly if this information is not used.
	Useful information.

Safety Notes

These Safety Notes include important information about installation, use, and maintenance of the Geyser P5.



- **ALWAYS:**
 - ◆ Connect to a grounded circuit.
 - ◆ Connect to operating voltages as specified on the product's spec sticker.
 - ◆ Disconnect from power before replacing the fuse.
 - ◆ Disconnect from its power source during periods of inactivity.
 - ◆ Use a safety cable when suspending overhead.
 - ◆ Heed all restrictions and warnings on the spec sticker.
 - ◆ Mount in a location with at least 20 in (50 cm) of ventilation.
 - ◆ Replace the fuse with the same type and rating.
 - ◆ Use Chauvet fluids.
 - ◆ Drain the tank before transporting or storing the product.
 - ◆ Keep the machine level.
 - ◆ Clean the machine after every use.
 - ◆ Clean around the product during and after use, as surfaces may become slippery.
 - ◆ Close both valves prior to filling with fluids.



- In the event of a serious operating problem, stop using immediately.
- All fog/haze machines may set off smoke detectors.
- **DO NOT:**
 - ◆ Open this product or attempt any repairs. It contains no user-serviceable parts.
 - ◆ Look at the light source when the product is on.
 - ◆ Use if the power cable is crimped or damaged.
 - ◆ Disconnect by pulling on the power cable.
 - ◆ Allow flammable materials close to the product when it is operating.
 - ◆ Touch the housing when it is on.
 - ◆ Block any ventilation holes/slots in the housing.
 - ◆ Connect to a dimmer or rheostat.
 - ◆ Carry the product by its power cable.
 - ◆ Operate in temperatures higher than 104°F (40°C).
 - ◆ Expose to environments that exceed the Ingress Protection (IP) rating.
 - ◆ Expose to rain or moisture.
 - ◆ Use outdoors.
 - ◆ Submerge.
 - ◆ Set this product on a flammable surface.
 - ◆ Touch the output nozzle. It may be hot for several hours after use.
 - ◆ Drink the fluid.
 - ◆ Add perfume, alcohol, gasoline or any other chemical to the fluid.
 - ◆ Use for space-heating purposes.
 - ◆ Overfill.



Keep this User Manual for future use. If the product is sold to someone else, be sure that they also receive this document.

2. Introduction

Product Overview

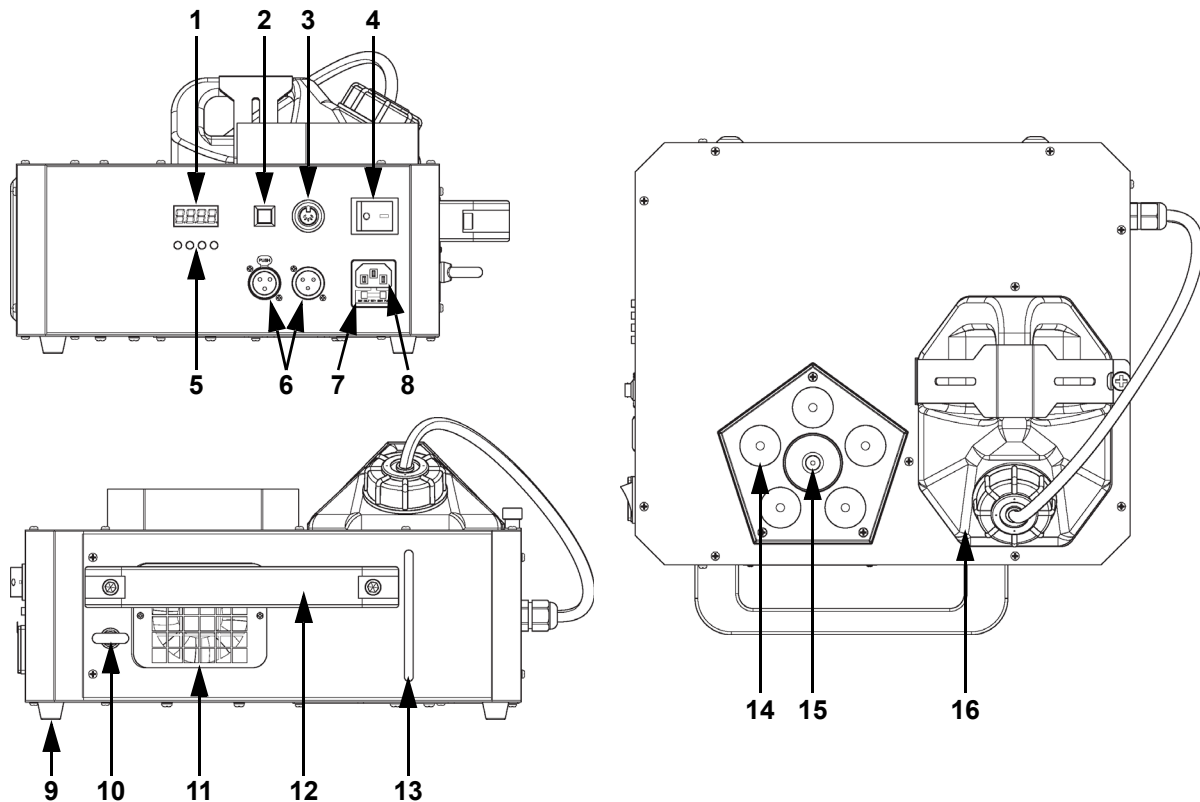

#	Name	#	Name	#	Name
1	Menu display	7	Fuse holder	12	Carry handle
2	Manual button	8	Power in	13	Fluid level indicator
3	Controller in	9	Feet for surface mounting (x4)	14	Penta-color LED (x5)
4	Power switch	10	Safety loop	15	Nozzle
5	Menu buttons	11	Fan	16	Fluid tank
6	DMX in/out				

Product Dimensions

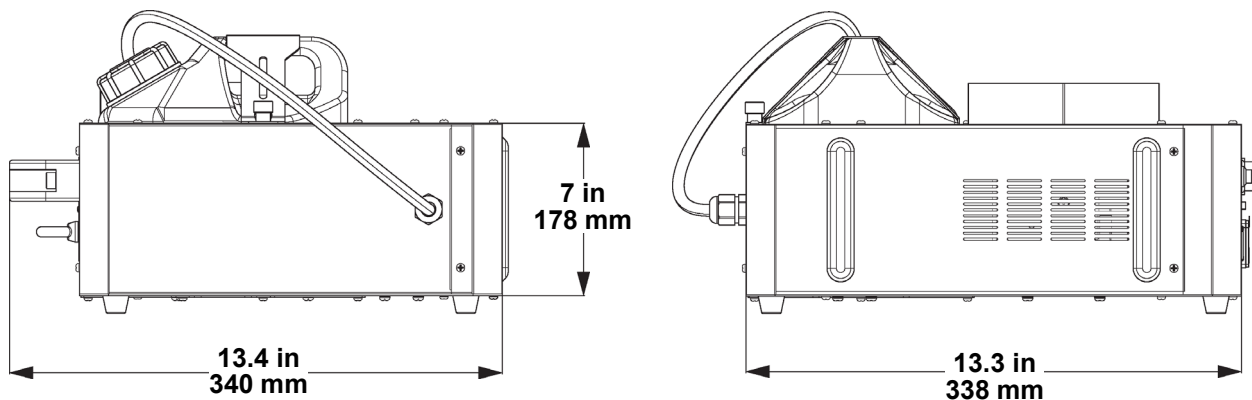

3. Setup

AC Power

The Geyser P5 has a fixed voltage power supply, and it can work with an input voltage range of either 120 VAC, 60 Hz or 230 VAC, 50 Hz, depending on the specific model.

To determine the product's power requirements (circuit breaker, power outlet, and wiring), use the current value listed on the label affixed to the product's back panel, or refer to the product's specifications chart.

The listed current rating indicates the product's average current draw under normal conditions.



- **Always connect the product to a protected circuit (a circuit breaker or fuse). Make sure the product has an appropriate electrical ground to avoid the risk of electrocution or fire.**
- **To eliminate unnecessary wear and improve its lifespan, during periods of non-use completely disconnect the product from power via breaker or by unplugging it.**



Never connect the product to a rheostat (variable resistor) or dimmer circuit, even if the rheostat or dimmer channel serves only as a 0 to 100% switch.

Fuse Replacement

1. Disconnect the product from power.
2. Wedge the tip of a flat-head screwdriver into the slot of the fuse holder.
3. Pry the fuse holder out of the housing.
4. Remove the blown fuse from the holder and replace with a fuse of the exact same type and rating.
5. Insert the fuse holder back in place and reconnect power.

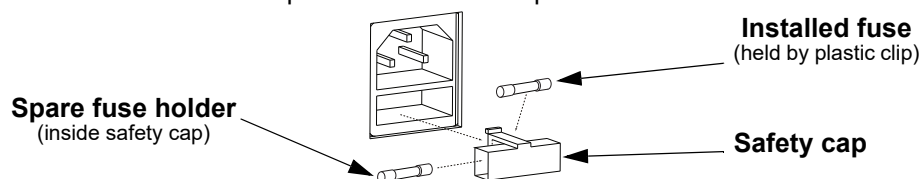

Disconnect the product from the power outlet before replacing the fuse.



Always replace a blown fuse with one of the same type and rating.



While operating the Geyser P5, make sure there is adequate fog fluid in the machine to prevent pump and heater damage. When the fog fluid level becomes low, simply add more fog fluid to continue using the Geyser P5.



This product may NOT be tilted. This product should be level when on a surface.

Mounting

Before mounting the product, read and follow the safety recommendations indicated in the [Safety Notes](#).

Orientation

The Geyser P5 may be mounted upright on a stable surface, inverted overhead, or sideways with the fluid tank cap oriented up. Always position the fluid tank with its cap in the uppermost position, above the fog fluid line. Make sure adequate ventilation is provided around the product.

Inverting the Tank

When mounting the Geyser P5 in an inverted position, invert the fluid tank to prevent leaking or spilling. To invert the fluid tank, follow the instructions below:

1. Remove the thumbscrew from the fluid tank bracket, as well as 3 spare screws around the fluid tank.
2. Slide the fluid tank bracket out of the slot.
3. Pull the fluid tank out and set it on a flat surface.
4. Detach the fluid tank plate by removing 4 screws.
5. Install the fluid tank plate to the opposite side with the 4 screws.
6. Install the 3 spare screws in the indicated threaded holes.
7. Insert the fluid tank and slide the end of the fluid tank bracket with no hole into the slot.
8. Secure the fluid tank bracket with the thumbscrew.

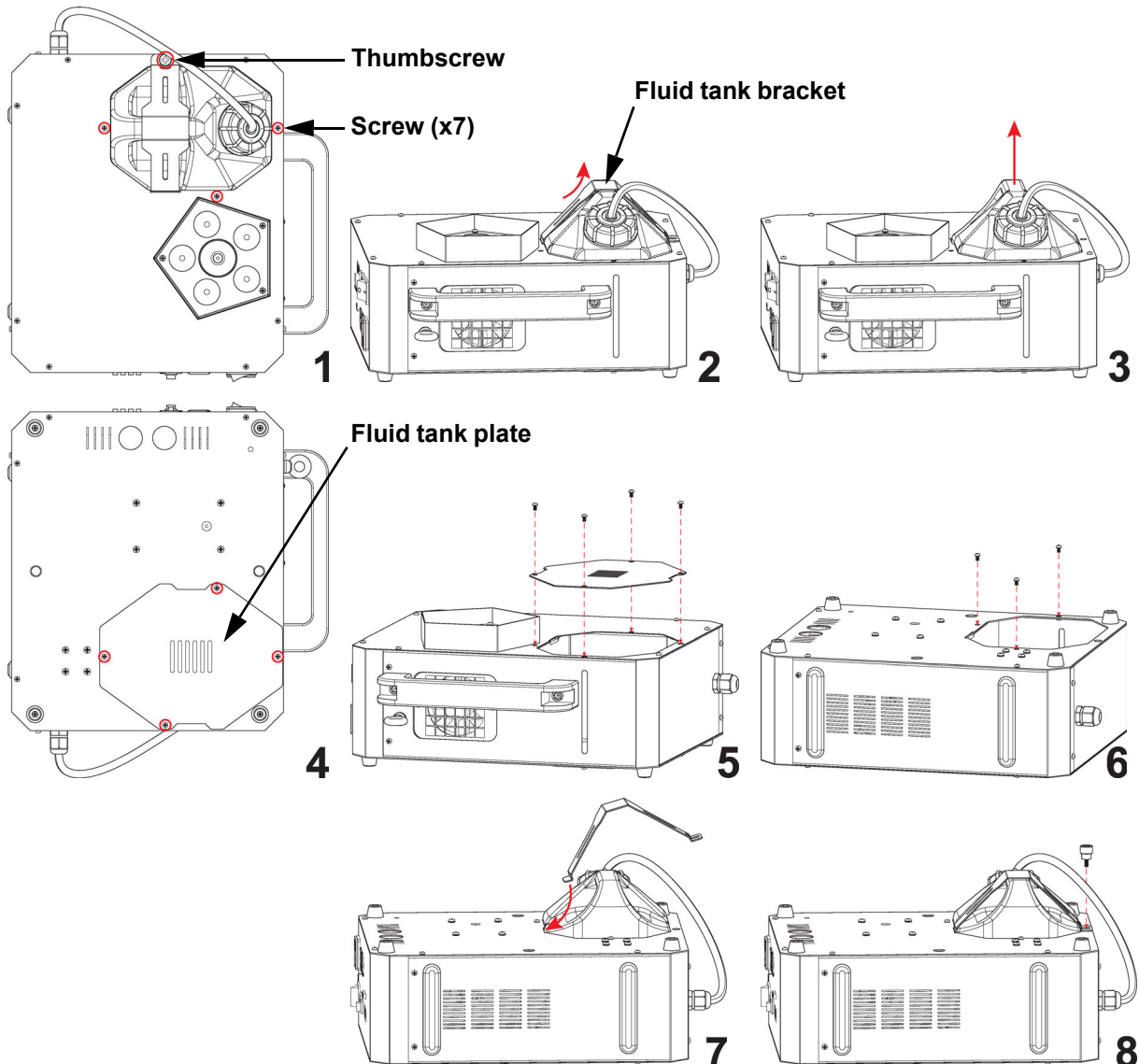

Rigging

- Before deciding on a location for the product, always make sure there is easy access to the product for maintenance and programming.
- Make sure that the structure and attachment points can support the weight before hanging the product (see the [Technical Specifications](#) section for weight information).
- When mounting the product overhead, always use a safety cable. Mount the product securely to a rigging point, such as an elevated platform or a truss.
- When rigging the product onto a truss, use a mounting clamp of appropriate weight capacity. The product has 2 10-mm threaded mounting holes, which are appropriate for this purpose.
- When mounting the product on the floor, make sure that the product and cables are away from people and vehicles.

Mounting Diagram

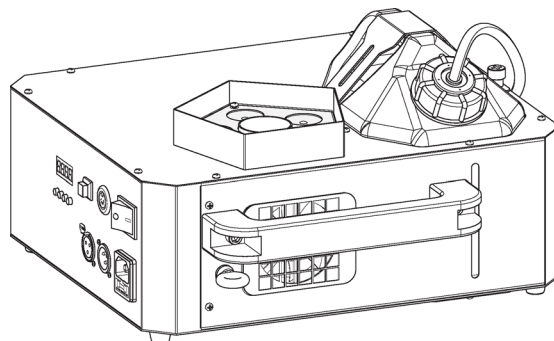

Surface mounting
Upwards fog output

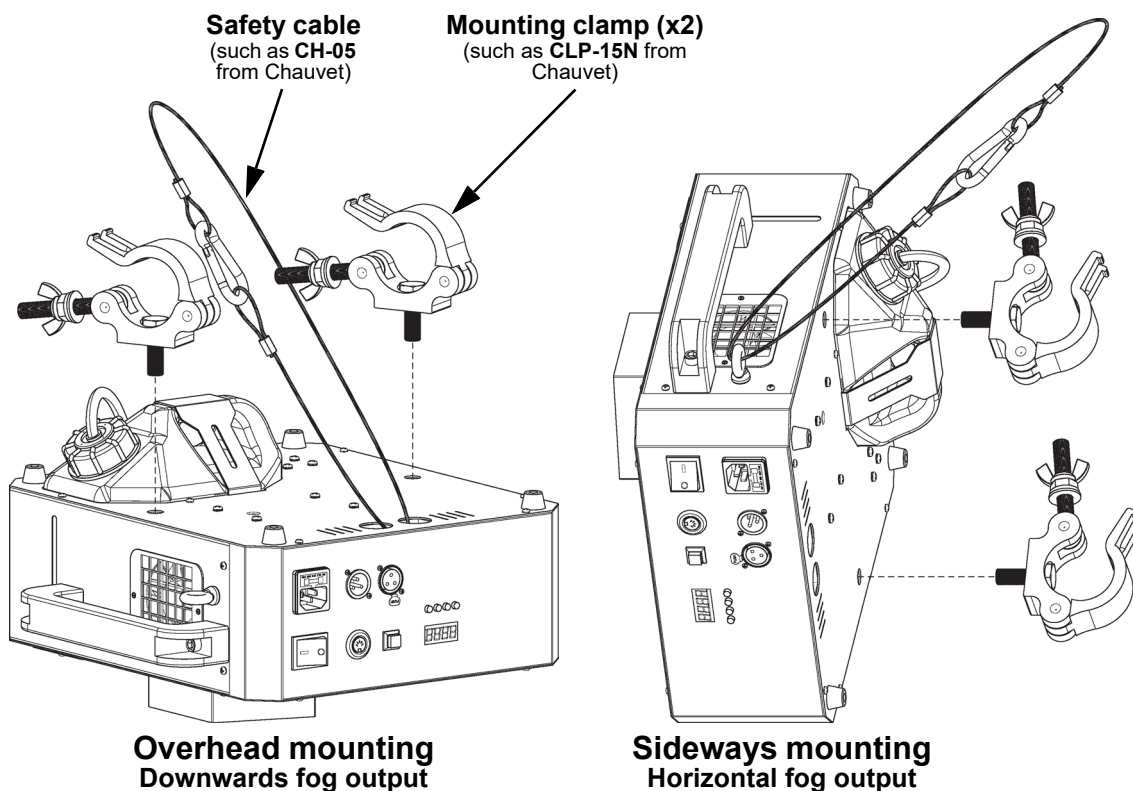

- To prevent leaking or spilling, always position the fluid tank with its cap in the uppermost position, above the fog fluid line.
- Do not fill the fluid tank to the cap when mounted horizontally.

4. Operation

Control Panel Operation

To access the control panel functions, use the four buttons located underneath the display. Please refer to the [Product Overview](#) to see the button locations on the control panel.

Button	Function
<MENU>	Press to find an operation mode or to back out of the current menu option
<UP>	Press to scroll up the list of options or to find a higher value
<DOWN>	Press to scroll down the list of options or to find a lower value
<ENTER>	Press to activate a menu option or a selected value
<MANUAL>	Triggers fog output

Menu Map

Refer to the Geyser P5 product page on www.chauvetdj.com for the latest menu map and software.

Main Level	Programming Levels	Description
Addr	1–512	Sets the DMX starting address
CH 1–4	oFF	No color output for the selected button
	Co 1	Red output for the selected button
	Co 2	Green output for the selected button
	Co 3	Blue output for the selected button
	Co 4	Amber output for the selected button
	Co 5	Ultraviolet output for the selected button
	Co 6	Hot pink output for the selected button
	Co 7	Pink output for the selected button
	Co 8	Yellow output for the selected button
	Co 9	Magenta output for the selected button
	Co10	Cyan output for the selected button
	Co11	White output for the selected button
	rand	Random output for the selected button

DMX Configuration

The Geyser P5 works with a DMX controller. Information about DMX is in the Chauvet DMX Primer, which is available from the Chauvet website chauvetlighting.com/downloads/DMX_Primer_rev05_WO.pdf.

Starting Address

The Geyser P5 uses 10 DMX channels, which defines the highest recommended address to **503**.

When selecting a starting DMX address, always consider the number of DMX channels the product uses. If the starting address is set too high, access to some channels could be restricted.

For information about the DMX protocol, download the DMX Primer from www.chauvetdj.com.

To select the starting address, do the following:

1. Press <MENU> repeatedly until **Addr** shows on the display.
2. Press <ENTER>.
3. Use <UP> or <DOWN> to select the starting address, from **001–512**.
4. Press <ENTER>.

DMX Channel Assignments and Values

DMX Charts

Channel	Function	Value	Percent/Setting
1	Fog	000 ⇔ 009	No function
		010 ⇔ 255	Fog output
2	Red	000 ⇔ 014	No function
		015 ⇔ 255	0–100%
3	Green	000 ⇔ 014	No function
		015 ⇔ 255	0–100%
4	Blue	000 ⇔ 014	No function
		015 ⇔ 255	0–100%
5	Amber	000 ⇔ 014	No function
		015 ⇔ 255	0–100%
6	Ultraviolet	000 ⇔ 014	No function
		015 ⇔ 255	0–100%
7	Color macro	000 ⇔ 009	No function
		010 ⇔ 255	Color macros
8	Color macro speed	000 ⇔ 009	No function
		010 ⇔ 255	Color macro speed, slow to fast
9	Strobe	000 ⇔ 009	No function
		010 ⇔ 255	Strobe, slow to fast
10	Dimmer	000 ⇔ 014	No function
		015 ⇔ 255	0–100%



The LEDs will automatically shut off after 60 seconds of sustained output. Reset the dimmer to re-enable LED output.

Geyser Wireless Remote Configuration



After connecting power, allow 5 to 6 minutes for the Geyser P5 to heat up before triggering fog output.

The included Geyser wireless remote control and receiver allows up to 4 preset colors or programs to be triggered from up to 100 ft (30 m) away.

To configure which color or program gets triggered by which button on the Geyser wireless remote control (<1>–<4>), follow the instructions below.

1. Press <MENU> repeatedly to select the button to configure, from **CH 1** (<1> and <MANUAL>), **CH 2** (<2>), **CH 3** (<3>), or **CH 4** (<4>).
2. Press <ENTER>.
3. Use <UP> or <DOWN> to select the output when the selected button is pressed, from **oFF** (no color output), **Co 1** (red), **Co 2** (green), **Co 3** (blue), **Co 4** (amber), **Co 5** (ultraviolet), **Co 6** (hot pink), **Co 7** (pink), **Co 8** (yellow), **Co 9** (magenta), **Co10** (cyan), **Co11** (white), or **rand** (random color output).
4. Press <ENTER>.

Geyser Wireless Remote Control Overview

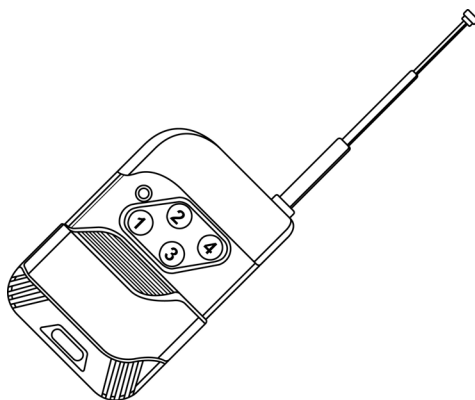

Ensure the Geyser remote has an unobstructed view of the product for maximum performance.

Manual Configuration



After connecting power, allow 5 to 6 minutes for the Geyser P5 to heat up before triggering fog output.

To set the color output when <MANUAL> is pressed, do the following:

1. Press <MENU> repeatedly until **CH 1** shows on the display.
2. Press <ENTER>.
3. Use <UP> or <DOWN> to select the color output when <MANUAL> is pressed, from **oFF** (no color output), **Co 1** (red), **Co 2** (green), **Co 3** (blue), **Co 4** (amber), **Co 5** (ultraviolet), **Co 6** (hot pink), **Co 7** (pink), **Co 8** (yellow), **Co 9** (magenta), **Co10** (cyan), **Co11** (white), or **rand** (random color output).
4. Press <ENTER>.

5. Maintenance

Product Maintenance

Dust build-up reduces light output performance and can cause overheating. This can lead to reduction of the light source's life and/or mechanical wear. To maintain optimum performance and minimize wear, clean all lighting products at least twice a month. However, be aware that usage and environmental conditions could be contributing factors to increase the cleaning frequency.

To clean the product, follow the instructions below:

1. Unplug the product from power.
2. Wait until the product is at room temperature.
3. Use a vacuum (or dry compressed air) and a soft brush to remove dust collected on the external surface/vents.
4. Clean all transparent surfaces with a mild soap solution, ammonia-free glass cleaner, or isopropyl alcohol.
5. Apply the solution directly to a soft, lint free cotton cloth or a lens cleaning tissue.
6. Softly drag any dirt or grime to the outside of the transparent surface.
7. Gently polish the transparent surfaces until they are free of haze and lint.



Always dry the transparent surfaces carefully after cleaning them.



Do not spin the fans using compressed air because they could be damaged.

Fog Machine Maintenance

Proper maintenance of Chauvet atmospheric products will increase the reliability and lifespan of products. Maintenance should be completed every 30-90 days, depending on how frequently products are used.



- **When performing maintenance, use Chauvet Fog Cleaner Quart (FCQ) for U.S., or cleaning Fluid 250 (CF250) for EU products. Run the fluid through the system to reduce the accumulation of particulate matter in the heating element.**
- **DO NOT allow the atmospheric product to become clogged. Once a product is clogged, the cleaning procedure is unlikely to effectively clear the clog.**

The recommended cleaning procedure is as follows:

1. Unplug the product from power.
2. Remove the hose from the fluid tank/reservoir. Remove the FCQ/CF250 screw cap and place the hose in the Fog Cleaner bottle.
3. Connect the product to power and allow it to warm up (if not already warmed up).
4. Run the FCQ/CF250 through the product in a well-ventilated area for 60-90 seconds of continuous, full output. Some products require multiple cycles to achieve this.



DO NOT allow the product to run dry!

5. Move the hose from the FCQ/CF250 to a small bottle with distilled water (only use distilled water, not tap or any other water or liquid). Run distilled water through the product for at least 30 seconds to clear any remaining cleaning solution from the pump and heater.



- **Turn off the product when not in use or when storing.**
- **DO NOT leave the cleaning solution in the product.**
- **DO NOT operate the product without fluid at any time.**
- **DO NOT leave Chauvet atmospheric fluid in the product tank/reservoir for more than 10 days without use.**



Fog Cleaner Quart (FCQ) and Cleaning Fluid 250 (CF250) were specifically developed by Chauvet to clean Chauvet atmospheric products equipped with heaters. Use FCQ/CF250 regularly, no longer than 90 days between cleanings (30-60 days if the product is used more frequently), to prevent shortening the life of the product.

Storage

Before storing the Chauvet atmospheric product, run FCQ/CF250 through the system as described in the cleaning procedure above and do not refill the tank with atmospheric fluid before storing the product.



Test-run the Chauvet atmospheric products monthly to achieve the best performance.

Chauvet does not guarantee products will withstand storage for long durations, even if the cleaning process is followed. Please use caution and test regularly to ensure the product continues to function properly.

6. Technical Specifications

Dimensions and Weight

Length	Width	Height	Weight
13.4 in (340 mm)	13.3 in (338 mm)	7 in (178 mm)	13.4 lb (6.1 kg)

Note: Dimensions in inches are rounded.

Power

Power Supply Type	Range	Voltage Selection
Model-specific	120 VAC, 60 Hz or 230 VAC, 50 Hz	Fixed
Parameter	120 V, 60 Hz	230 V, 50 Hz
Consumption	670 W	670 W
Operating Current	5.6 A	2.8 A
Fuse	F 7 A, 250 V	F 7 A, 250 V
Power I/O	U.S./Worldwide	UK/Europe
Power input connector	IEC	IEC
Power cable plug	Edison (U.S.)	Local Plug

Operation

Heat-Up Time	Tank Capacity	Fluid Consumption	Fog Output
5 min	0.7 gal (2.5 L)	91 ml/min	13,500 cfm

Light Source

Type	Color	Quantity	Power	Current	Lifespan
LED	Penta-color RGBA+UV	5	7 W	2.6 A	50,000 hours

Photometrics

Illuminance @ 2 m
1,036 lux

Thermal

Maximum External Temperature	Cooling System
104 °F (40 °C)	Fan-assisted convection

DMX

I/O Connector	Channel Range
3-pin XLR	10

Ordering

Product Name	Item Code	UPC Number
Geyser P5 (120 V)	05071324	781462216726
Geyser P5 (230 V)	05071325	781462216733



Contact Us

General Information	Technical Support
Chauvet World Headquarters	
Address: 3360 Davie Rd., Suite 509 Davie, FL 33314 Voice: (954) 577-4455 Fax: (954) 929-5560 Toll Free: (800) 762-1084	Voice: (844) 393-7575 Fax: (954) 756-8015 Email: chauvetcs@chauvetlighting.com Website: www.chauvetdj.com
Chauvet U.K.	
Address: Pod 1 EVO Park Little Oak Drive, Sherwood Park Nottinghamshire, NG15 0EB UK Voice: +44 (0) 1773 511115 Fax: +44 (0) 1773 511110	Email: UKtech@chauvetlighting.eu Website: www.chauvetdj.eu
Chauvet Benelux	
Address: Vaartlaan 9 9800 Deinze Belgium Voice: +32 9 388 93 97	Email: BNLtech@chauvetlighting.eu Website: www.chauvetdj.eu
Chauvet France	
Address: 3, Rue Ampère 91380 Chilly-Mazarin France Voice: +33 1 78 85 33 59	Email: FRtech@chauvetlighting.fr Website: www.chauvetdj.eu
Chauvet Germany	
Address: Bruno-Bürgel-Str. 11 28759 Bremen Germany Voice: +49 421 62 60 20	Email: DEtech@chauvetlighting.de Website: www.chauvetdj.eu
Chauvet Mexico	
Address: Av. de las Partidas 34 - 3B (Entrance by Calle 2) Zona Industrial Lerma Lerma, Edo. de México, CP 52000 Voice: +52 (728) 690-2010	Email: servicio@chauvet.com.mx Website: www.chauvetdj.mx

Warranty & Returns

For warranty terms and conditions and return information, please visit our website.

For customers in the United States and Mexico: www.chauvetlighting.com/warranty-registration.

For customers in the United Kingdom, Republic of Ireland, Belgium, the Netherlands, Luxembourg, France, and Germany: www.chauvetlighting.eu/warranty-registration.