

EVE F-160ZQ

User Manual



Edition Notes

The EVE F-160ZQ User Manual includes a description, safety precautions, installation, programming, operation, and maintenance instructions for the EVE F-160ZQ as of the release date of this edition.

Trademarks

Chauvet, Chauvet DJ, the Chauvet logo, and EVE are registered trademarks or trademarks of Chauvet & Sons, LLC (d/b/a Chauvet and Chauvet Lighting) in the United States and other countries. Other company and product names and logos referred to herein may be trademarks of their respective companies.

Copyright Notice

The works of authorship contained in this manual, including, but not limited to, all designs, text, and images are owned by Chauvet.

© Copyright 2024 Chauvet & Sons, LLC. All rights reserved.

Electronically published by Chauvet in the United States of America.

Manual Use

Chauvet authorizes its customers to download and print this manual for professional information purposes only. Chauvet expressly prohibits the usage, copy, storage, distribution, modification, or printing of this manual or its content for any other purpose without written consent from Chauvet.

Document Printing

For best results, print this document in color, on letter size paper (8.5 x 11 in), double-sided. If using A4 paper (210 x 297 mm), configure the printer to scale the content accordingly.

Intended Audience

Any person installing, operating, and/or maintaining this product should completely read through the guide that shipped with the product, as well as this manual, before installing, operating, or maintaining this product.

Disclaimer

Chauvet believes that the information contained in this manual is accurate in all respects. However, Chauvet assumes no responsibility and specifically disclaims any and all liability to any party for any loss, damage, or disruption caused by any errors or omissions in this document, whether such errors or omissions result from negligence, accident, or any other cause. Chauvet reserves the right to revise the content of this document without any obligation to notify any person or company of such revision; however, Chauvet has no obligation to make, and does not commit to make, any such revisions.

Document Revision

Go to www.chauvetdj.com for the latest version.

Revision	Date	Description
1	09/2024	Initial release.

TABLE OF CONTENTS

1. Before You Begin	1
What Is Included	1
Unpacking Instructions	1
Claims	1
Text Conventions	1
Symbols	1
Safety Notes	2
2. Introduction	3
Product Overview	3
Product Dimensions	4
3. Setup	5
AC Power	5
Fuse Replacement	5
Power Linking	5
Mounting	6
Orientation	6
Rigging	6
4. Operation	7
Control Panel Operation	7
Menu Map	7
DMX Configuration	10
Personality and Starting Address	10
D-Fi USB Connectivity	11
D-Fi USB Compatibility	11
D-Fi USB Configuration	11
DMX Charts	12
Standalone Configuration	14
Virtual Color Wheel	14
Color Temperature	14
Manual Color Mixer	14
Auto Show	14
Dimmer Curve	14
Dimmer Mode	15
DMX Loss	15
Fan Mode	15
Back Light	15
Information	15
Upgrade Firmware	15
Factory Reset	15
Wired Master/Slave Mode	16
D-Fi USB Master/Slave Mode	16
5. Maintenance	17
Product Maintenance	17
6. Technical Specifications	18
Contact Us	19
Warranty & Returns	19

1. Before You Begin

What Is Included

- EVE F-160ZQ
- Power cable
- Barn doors
- Gel frame
- Quick Reference Guide

Unpacking Instructions

Carefully unpack the product immediately and check the container to make sure all the parts are in the package and are in good condition.

Claims





If the box or the contents (the product and included accessories) appear damaged from shipping, or show signs of mishandling, notify the carrier immediately, not Chauvet. Failure to report damage to the carrier immediately may invalidate a claim. In addition, keep the box and contents for inspection.

For other issues, such as missing components or parts, damage not related to shipping, or concealed damage, file a claim with Chauvet within 7 days of delivery.

Text Conventions

Convention	Meaning
1–512	A range of values
50/60	A set of values of which only one can be chosen
Settings	A menu option not to be modified
<ENTER>	A key to be pressed on the product's control panel
ON	A value to be entered or selected

Symbols

Symbol	Meaning
	Electrical warning. Not following these instructions may cause electrical damage to the product, accessories, or the user.
	Critical installation, configuration, or operation information. Not following these instructions may make the product not work, cause damage to the product, or cause harm to the operator.
	Important installation or configuration information. The product may not function correctly if this information is not used.
	Useful information.

Safety Notes

These Safety Notes include important information about installation, use, and maintenance of the EVE F-160ZQ.



■ **ALWAYS:**

- ◆ Connect to a grounded circuit.
- ◆ Connect to operating voltages as specified on the product's spec sticker.
- ◆ Disconnect from power before replacing the fuse.
- ◆ Disconnect from its power source during periods of inactivity.
- ◆ Use a safety cable when suspending overhead.
- ◆ Heed all restrictions and warnings on the spec sticker.
- ◆ Mount in a location with at least 20 in (50 cm) of ventilation.
- ◆ Replace the fuse with the same type and rating.
- ◆ Use a clamp with a captive bolt when a single hanging bracket is used.



- In the event of a serious operating problem, stop using immediately.

■ **DO NOT:**

- ◆ Open this product or attempt any repairs. It contains no user-serviceable parts.
- ◆ Look at the light source when the product is on.
- ◆ Use if the power cable is crimped or damaged.
- ◆ Disconnect by pulling on the power cable.
- ◆ Allow flammable materials close to the product when it is operating.
- ◆ Touch the housing when it is on.
- ◆ Block any ventilation holes/slots in the housing.
- ◆ Connect to a dimmer or rheostat.
- ◆ Carry the product by its power cable.
- ◆ Operate in temperatures higher than 104°F (40°C).
- ◆ Expose to environments that exceed the Ingress Protection (IP) rating.
- ◆ Expose to rain or moisture.
- ◆ Use outdoors.
- ◆ Submerge.
- ◆ Leave outdoors for extended periods of time.
- ◆ Expose to corrosive environmental conditions such as temperature, humidity, salinity, pressure, radiation, or shock.
- ◆ Set this product on a flammable surface.



Keep this User Manual for future use. If the product is sold to someone else, be sure that they also receive this document.

2. Introduction

Product Overview

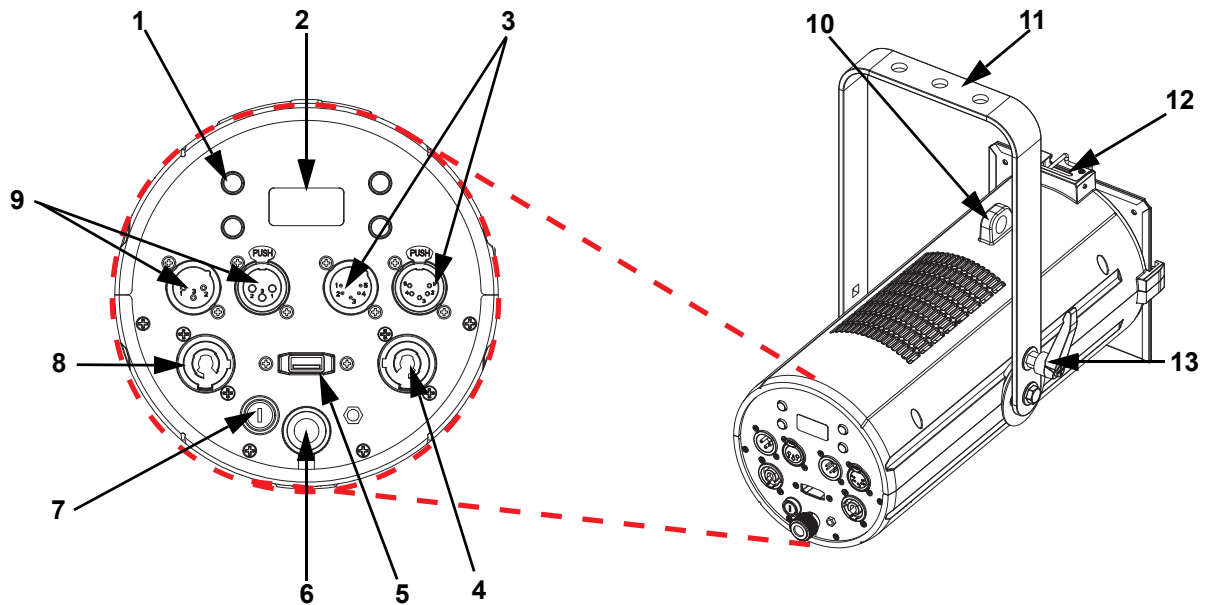

#	Name	#	Name
1	Menu buttons	8	Power in
2	LCD display screen	9	3-pin DMX in/out
3	5-pin DMX in/out	10	Safety cable loop
4	Power out	11	Mounting bracket
5	D-Fi USB port	12	Gel holder locking clip
6	Zoom thumbscrew	13	Bracket adjustment knob
7	Fuse holder		



WARNING! DO NOT plug anything other than a D-Fi USB or memory drive into the USB type A port. Doing so may cause damage to the product.

Product Dimensions

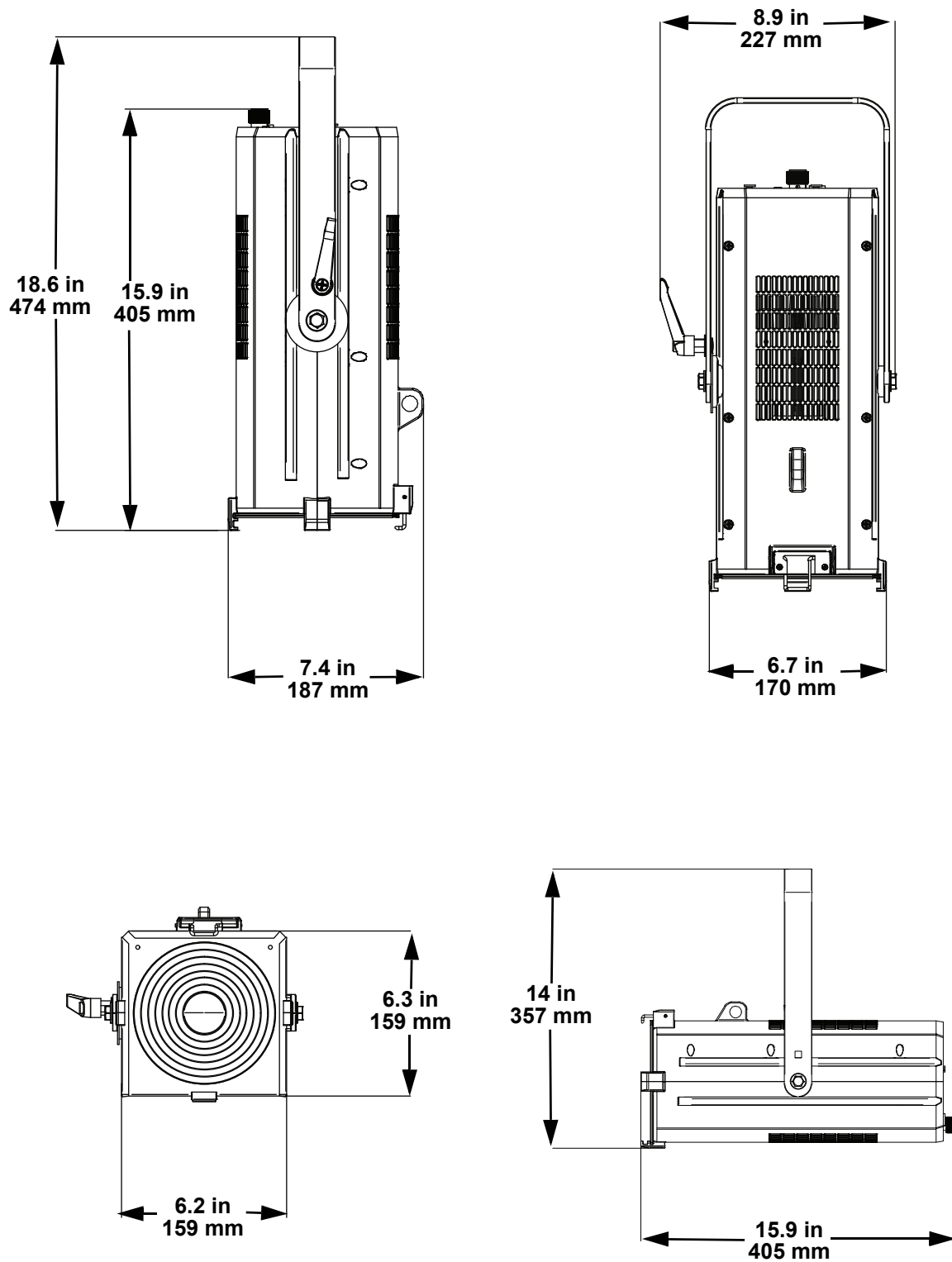

3. Setup

AC Power

The EVE F-160ZQ has an auto-ranging power supply and it can work with an input voltage range of 100 to 240 VAC, 50/60 Hz.

To determine the product's power requirements (circuit breaker, power outlet, and wiring), use the current value listed on the label affixed to the product's back panel, or refer to the product's specifications chart.

The listed current rating indicates the product's average current draw under normal conditions.



- **Always connect the product to a protected circuit (a circuit breaker or fuse). Make sure the product has an appropriate electrical ground to avoid the risk of electrocution or fire.**
- **To eliminate unnecessary wear and improve its lifespan, during periods of non-use completely disconnect the product from power via breaker or by unplugging it.**



Never connect the product to a rheostat (variable resistor) or dimmer circuit, even if the rheostat or dimmer channel serves only as a 0 to 100% switch.

Fuse Replacement

1. Disconnect the product from power.
2. Wedge the tip of a flat-head screwdriver into the slot of the fuse holder.
3. Pry the fuse holder out of the housing.
4. Remove the blown fuse from the holder and replace with a fuse of the exact same type and rating.
5. Insert the fuse holder back in place and reconnect power.



Disconnect the product from the power outlet before replacing the fuse.



Always replace a blown fuse with one of the same type and rating.

Power Linking

This product provides power linking via the outlet located in the back of the product. See the diagram below for further explanation.

Power Linking Diagram

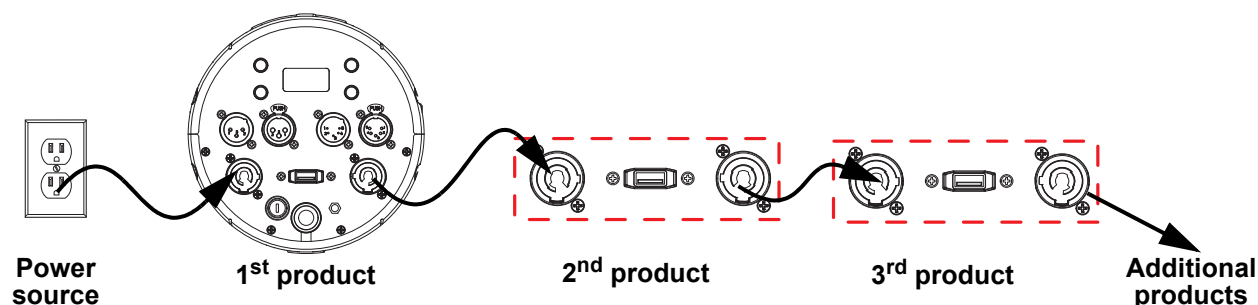

It is possible to link up to 9 EVE F-160ZQ products on 120 VAC or up to 16 products on 230 VAC.



The power linking diagram shown above corresponds to the North American version of the product ONLY! If using the product in other markets, consult with the local Chauvet distributor as power linking connectors and requirements may differ by country or region.

Mounting

Before mounting the product, read and follow the safety recommendations indicated in the [Safety Notes](#).

Orientation

The EVE F-160ZQ may be mounted in any position; however, make sure adequate ventilation is provided around the product.

Rigging

- Before deciding on a location for the product, always make sure there is easy access to the product for maintenance and programming.
- Make sure that the structure and attachment points can support the weight before hanging the product (see the [Technical Specifications](#) section for weight information).
- When mounting the product overhead, always use a safety cable. Mount the product securely to a rigging point, such as an elevated platform or a truss.
- When rigging the product onto a truss, use a mounting clamp of appropriate weight capacity. The bracket has a 13-mm hole, which is appropriate for this purpose.
- The bracket adjustment knobs allow for directional adjustment when aiming the product to the desired angle. Only loosen or tighten the bracket knobs manually. Using tools could damage the knobs.
- When power linking multiple products, mount the products close enough for power linking cables to reach.
- When mounting the product on the floor, make sure that the product and cables are away from people and vehicles.

Mounting Diagram

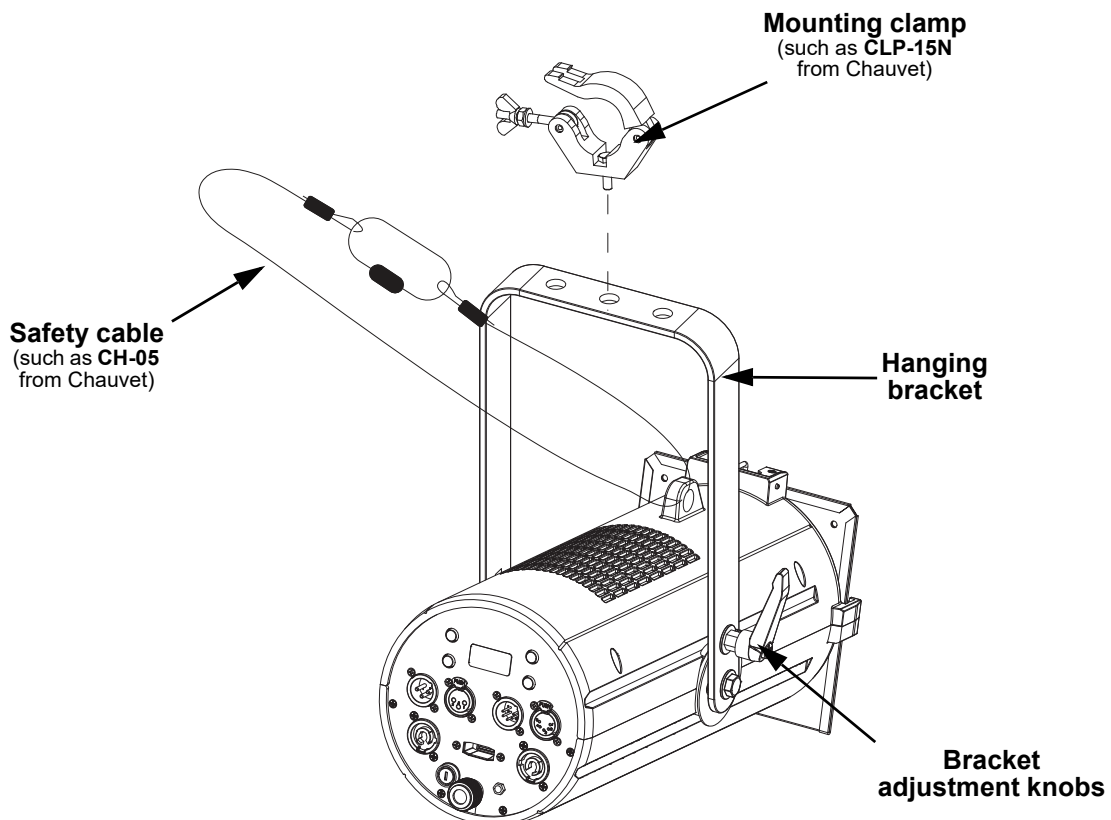

To prevent accidental loosening when using a single mounting clamp, be sure to use a clamp with a captive bolt.

4. Operation

Control Panel Operation

To access the control panel functions, use the four buttons located underneath the display. Please refer to the [Product Overview](#) to see the button locations on the control panel.

Button	Function
<MENU>	Press to find an operation mode or to back out of the current menu option
<UP>	Press to scroll up the list of options or to find a higher value
<DOWN>	Press to scroll down the list of options or to find a lower value
<ENTER>	Press to activate a menu option or a selected value

Menu Map

Refer to the EVE F-160ZQ product page on www.chauvetdj.com for the latest menu map and software.

Main Menu	Programming Levels			Description
DMX Address	001–502			Selects DMX starting address
DMX Channel	3 Ch			3-channel DMX mode
	4 Ch			4-channel DMX mode
	11Ch			11-channel DMX mode
Virtual Color Wheel	Virtual Color Wheel	C3050–Md Yellow	Dimmer (000–255)	Selects preset colors
		C3040–Lt Yellow		
		C3240–Amb Yellow		
		C2340–Vlt Amber		
		C2040–Lt Amber		
		C2050–Md Amber		
		C2060–Dk Amber		
		C1050–Lt Red		
		C1080–Md Red		
		C1020–NC Pink		
		C1030–Md Pink		
		C1630–Dk pink		
		C1250–Md Red Amber		
		C1060–Dk Red Amber		
		C1650–Magenta		
		C6170–Dk Magenta		
		C6020–Lt Lavender		

Main Menu	Programming Levels		Description
Virtual Color Wheel (cont.)	Virtual Color Wheel (cont.)	C5030–Lt Blue	Dimmer (000–255) Selects preset colors
		C5020–Vlt Blue	
		C5430–Lt Blue2	
		C5070–Blue	
		C5050–Md Blue	
		C5060–Dk Blue	
		C5690–Indigo	
		C5080–VDK Blue	
		C5081–Vdk Blue2	
		C4370–Yel Green	
		C4070–Green	
		C4550–Turquoise	
		C4560–Aqua	
		C4570–Blue Green	
	Color Temperature	2800K	Dimmer (000–255) Hue (-025–025) Selects preset color temperature
		2900K	
		3000K	
		3100K	
		3200K	
		3300K	
		3400K	
		3500K	
		3600K	
		3700K	
		3800K	
		3900K	
		4000K	
		4100K	
		4200K	
		4300K	
		4400K	
		4500K	
		4600K	
		4700K	
		4800K	
		4900K	
		5000K	

Main Menu	Programming Levels			Description
Virtual Color Wheel (cont.)	Color Temperature (cont.)	5100K	Dimmer (000–255) Hue (-025–025)	Selects preset color temperature
		5200K		
		5300K		
		5400K		
		5500K		
		5600K		
		5700K		
		6000K		
		6500K		
		7000K		
		7500K		
		8000K		
Manual Color Mixer	Red	000–255	Combines red, green, blue, and white to make a custom color (0–100%)	
	Green			
	Blue			
	White			
Auto Show	Auto 1–5	001–100		Selects the auto program, and adjusts the speed of auto programs
Master/ Slave	Master			Sets unit to either master or slave
	Slave			
Dimmer Curve	S–Curve			Sets the dimmer curve
	Linear			
	Square			
	Inverse Square			
Dimmer Mode	Off			Linear dimmer
	Dimmer 1			Dimming curves: Dimmer 1 (fast) to Dimmer 3 (slow)
	Dimmer 2			
	Dimmer 3			
DMX Loss	Hold			Holds the last setting when DMX signal was lost
	Black			Blacks out the unit when DMX signal is lost
	Auto			Sets the unit to Auto mode when DMX signal is lost
Fan Mode	Auto Speed			Sets fan to auto – fan speeds adjusts according to product temperature
	On			Turns fan to on
	Off			Sets fan to off
	Silent			Sets fan to silent mode
Back Light	10S			Turns off display backlight after 10 seconds of inactivity
	30S			Turns off display backlight after 30 seconds of inactivity
	2Min			Turns off display backlight after 2 minutes of inactivity
	Always On			Display backlight remains on

Main Menu	Programming Levels	Description
Information	Fixture Hours <_ _ _ _ H>	Displays the total hours the product has been powered on
	LED Hours <_ _ _ _ H>	Displays the total LED hours
	Version <V_ _ _ _ _>	Displays firmware version
	UID <_ _ _ _ _>	Displays fixture UID
Upgrade Firmware	Only this fixture	Selects an update file for this product, or shows "No such file!"
	Multiple Fixture	Selects an update file for this and connected Shocker P2 products, or shows "No such file!"
	Other Fixture Type	Selects an update file for other connected products, or shows "No such file!"
Factory Reset	No	Resets settings to factory default
	Yes	

DMX Configuration

The EVE F-160ZQ works with a DMX controller. Information about DMX is in the Chauvet DMX Primer, which is available from the Chauvet website chauvetlighting.com/downloads/DMX_Primer_rev05_WO.pdf.

Personality and Starting Address

The EVE F-160ZQ uses up to 11 DMX channels in the **11Ch** DMX mode, which defines the highest configurable/recommended address to **502**.

When selecting a starting DMX address, always consider the number of DMX channels the DMX mode uses. If the starting address is set too high, access to some channels could be restricted.

For information about the DMX protocol, download the DMX Primer from www.chauvetdj.com.

To select the personality and starting address, do the following:

1. Press **<MENU>** repeatedly until **3Ch**, **4Ch**, or **11Ch** shows on the display.
2. Press **<ENTER>**.
3. Use **<UP>** or **<DOWN>** to select the starting address, from **001–502**.
4. Press **<ENTER>**.

D-Fi USB Connectivity

The EVE F-160ZQ is able to become a D-Fi wireless receiver/transmitter with the use of the D-Fi USB from Chauvet DJ. Simply set the product's DMX Personality and DMX Address, set the DIP switch D-Fi receiving/transmitting channel, then plug it into the D-Fi USB port.



WARNING! DO NOT plug anything other than a D-Fi USB or memory drive into the USB type A port. Doing so may cause damage to the product.



Once plugged in, the D-Fi USB will take over the product. Wired DMX and manual display control / menu buttons will be unavailable until the D-Fi USB is unplugged. The priority levels are:

1. D-Fi USB
2. Wired DMX
3. Manual Digital Display/Menu Buttons

D-Fi USB Compatibility

The D-Fi USB can receive a DMX signal from the D-Fi Hub and the FlareCON Air 2 as well as other D-Fi USB products.

D-Fi USB Configuration

1. Set the DMX Personality and DMX address on the EVE F-160ZQ.
2. Use the Chart provided to set **BOTH**:
 - the Channel, and then
 - The Receiving or Transmitting option

NOTE: DIP Switch 5 is for Transmitting OR Receiving, please choose carefully.

D-Fi USB DIP Switch Channels

Receiving →						Receiving →						Transmitting →						Transmitting →					
Ch.	1	2	3	4	T/R	Ch.	1	2	3	4	T/R	Ch.	1	2	3	4	T/R	Ch.	1	2	3	4	T/R
1						9						1						9					
2						10						2						10					
3						11						3						11					
4						12						4						12					
5						13						5						13					
6						14						6						14					
7						15						7						15					
8						16						8						16					

DMX Channel Assignments and Values

DMX Charts

3Ch	4Ch	11Ch	Function	Value	Percent/Setting
1	–	1	Dimmer	000 ⇔ 255	0–100%
–	1	2	Red	000 ⇔ 255	0–100%
–	2	3	Green	000 ⇔ 255	0–100%
–	3	4	Blue	000 ⇔ 255	0–100%
–	4	5	White	000 ⇔ 255	0–100%
2	–	6	Strobe	000 ⇔ 010	No function
				011 ⇔ 255	Strobe, slow to fast
				000 ⇔ 005	No function
				006 ⇔ 013	Md yellow
				014 ⇔ 021	Lt yellow
				022 ⇔ 029	Amb yellow
				030 ⇔ 037	Vlt amber
				038 ⇔ 045	Lt amber
				046 ⇔ 053	Md amber
				054 ⇔ 061	Dk amber
				062 ⇔ 069	Lt red
				070 ⇔ 077	Md red
				078 ⇔ 085	NC pink
				086 ⇔ 093	Md pink
				094 ⇔ 101	Dk pink
				102 ⇔ 109	Md red amber
				110 ⇔ 117	Dk red amber
				118 ⇔ 125	Magenta
				126 ⇔ 133	Dk magenta
				134 ⇔ 141	Lt lavender
				142 ⇔ 149	Lt blue
				150 ⇔ 157	Vlt blue
				158 ⇔ 165	Lt blue2
				166 ⇔ 173	Blue
				174 ⇔ 181	Md blue
				182 ⇔ 189	Dk blue
				190 ⇔ 197	Indigo
				198 ⇔ 205	Vdk blue
				206 ⇔ 213	Vdk blue 2
				214 ⇔ 221	Yel green
				222 ⇔ 229	Green
				230 ⇔ 237	Turquoise
				238 ⇔ 245	Aqua
				246 ⇔ 250	Blue green
				251 ⇔ 255	No function
				000 ⇔ 005	No function
				006 ⇔ 255	2800K-8000K
3	–	8	CTC	000 ⇔ 005	No function
				006 ⇔ 255	2800K-8000K

3Ch	4Ch	11Ch	Function	Value	Percent/Setting
-	-	9	Auto program	000 ⇔ 010	No function
				011 ⇔ 060	Auto program 1
				061 ⇔ 110	Auto program 2
				111 ⇔ 160	Auto program 3
				161 ⇔ 210	Auto program 4
				211 ⇔ 255	Auto program 5
-	-	10	Auto program speed	000 ⇔ 255	Auto program speed, slow to fast
-	-	11	Control	000 ⇔ 007	No function
				008 ⇔ 015	Dimmer reset
				016 ⇔ 023	Dimmer mode off
				024 ⇔ 031	Dimmer mode 1
				032 ⇔ 039	Dimmer mode 2
				040 ⇔ 047	Dimmer mode 3
				048 ⇔ 055	Fan auto
				056 ⇔ 063	Fan on
				064 ⇔ 071	Fan off
				072 ⇔ 079	Fan silent
				080 ⇔ 255	No function

Standalone Configuration

Set the product in one of the standalone modes to operate without a DMX controller.



Never connect a product that is operating in any standalone mode to a DMX string connected to a DMX controller. Products in standalone mode may transmit DMX signals that could interfere with the DMX signals from the controller.

Virtual Color Wheel

To run the EVE F-160ZQ with a virtual color wheel, follow the instructions below.

1. Press **<MENU>** repeatedly until **Virtual Color Wheel** shows on the display.
2. Press **<ENTER>**.
3. Use **<UP>** or **<DOWN>** to select the desired **Virtual Color Wheel**.
4. Press **<ENTER>**.
5. Use **<UP>** or **<DOWN>** to select a custom color.
6. Press **<ENTER>**.
7. Use **<UP>** or **<DOWN>** to increase or decrease the value of the dimmer, from **000–255**.
8. Press **<ENTER>**.

Color Temperature

To run the EVE F-160ZQ with a preset color temperature, follow the instructions below.

1. Press **<MENU>** repeatedly until **Virtual Color Wheel** shows on the display.
2. Press **<ENTER>**.
3. Use **<UP>** or **<DOWN>** to select **Color Temperature**.
4. Press **<ENTER>**.
5. Use **<UP>** or **<DOWN>** to select from **2800K, 2900K, 3000K, 3100K, 3200K, 3300K, 3400K, 3500K, 3600K, 3700K, 3800K, 3900K, 4000K, 4100K, 4200K, 4300K, 4400K, 4500K, 4600K, 4700K, 4800K, 4900K, 5000K, 5100K, 5200K, 5300K, 5400K, 5500K, 5600K, 5700K, 6000K, 6500K, 7000K, 7500K, or 8000K**.

Manual Color Mixer

To combine colors with a manual color mixer, follow the instructions below.

1. Press **<MENU>** repeatedly until **Virtual Color Wheel** shows on the display.
2. Press **<ENTER>**.
3. Use **<UP>** or **<DOWN>** to select **Manual Color Mixer**.
4. Press **<ENTER>**.
5. Use **<UP>** or **<DOWN>** to select from **Red, Green, Blue, or White**.
6. Press **<ENTER>**.
7. Use **<UP>** or **<DOWN>** to increase or decrease the value, from **000–255**.
8. Press **<ENTER>**.

Auto Show

To run the EVE F-160ZQ with an auto program, do the following:

1. Press **<MENU>** repeatedly until **Auto Show** shows on the display.
2. Press **<ENTER>**.
3. Use **<UP>** or **<DOWN>** to select an auto program, from **Auto 1–5**.
4. Press **<ENTER>**.
5. Use **<UP>** or **<DOWN>** to increase or decrease the value, from **001–100**.
6. Press **<ENTER>**.

Dimmer Curve

To select the dimmer curve on the EVE F-160ZQ, do the following:

1. Press **<MENU>** repeatedly until **Dimmer curve** shows on the display.
2. Press **<ENTER>**.
3. Use **<UP>** or **<DOWN>** to select a dimmer curve, from **S-Curve, Linear, Square, or Inverse Square**.
4. Press **<ENTER>**.

Dimmer Mode

To select the dimmer mode on the EVE F-160ZQ, do the following:

1. Press **<MENU>** repeatedly until **Dimmer Mode** shows on the display.
2. Press **<ENTER>**.
3. Use **<UP>** or **<DOWN>** to select a dimmer mode, from **Dimmer 1–3** (fast to slow), or **Off**.
4. Press **<ENTER>**.

DMX Loss

To set the DMX Loss mode on the EVE F-160ZQ, follow the instructions below:

1. Press **<MENU>** repeatedly until **DMX Loss** shows on the display.
2. Press **<ENTER>**.
3. Use **<UP>** or **<DOWN>** to select from **hold** (holds the last setting), **Auto** (sets the unit to auto mode), or **black** (blacks out the product).
4. Press **<ENTER>**.

Fan Mode

To set the fan mode on the EVE F-160ZQ, follow the instructions below:

1. Press **<MENU>** repeatedly until **Fan Mode** shows on the display.
2. Press **<ENTER>**.
3. Use **<UP>** or **<DOWN>** to select a fan mode, from **Auto Speed**, **On**, **Off**, or **Silent**.
4. Press **<ENTER>**.

Back Light

To set the back light timing on the EVE F-160ZQ, do the following:

1. Press **<MENU>** repeatedly until **Back Light** shows on the display.
2. Press **<ENTER>**.
3. Use **<UP>** or **<DOWN>** to select **10S** (Turns of display light after 10 seconds of inactivity), **30S** (Turns of display light after 30 seconds of inactivity), **2Min** (Turns of display light after 2 minutes of inactivity), or **Always On** (display back light remains on).
4. Press **<ENTER>**.

Information

To view information on the EVE F-160ZQ, do the following:

1. Press **<MENU>** repeatedly until **Information** shows on the display.
2. Press **<ENTER>**.

Upgrade Firmware

To update the firmware on the EVE F-160ZQ, do the following:

1. Press **<MENU>** repeatedly until **Upgrade Firmware** shows on the display.
2. Press **<ENTER>**.
3. Use **<UP>** or **<DOWN>** to select **Only this Fixture** (selects an update file for this product, or shows "No such file!"), **Multiple Fixture** (Selects an update file for this and connected EVE F-160ZQ products, or shows "No such file!"), or **Other Fixture Type** (selects an update file for other connected products, or shows "No such file!").
4. Press **<ENTER>**.

Factory Reset

To set the back light timing on the EVE F-160ZQ, do the following:

1. Press **<MENU>** repeatedly until **Factory Reset** shows on the display.
2. Press **<ENTER>**.
3. Use **<UP>** or **<DOWN>** to select **No** (Maintains current settings) or **Yes** (resets settings to factory default).
4. Press **<ENTER>**.

Wired Master/Slave Mode

The Master/Slave mode allows a single EVE F-160ZQ product (the “master”) to control the actions of one or more EVE F-160ZQ products (the “slaves”) without the need of a DMX controller. The master product will be set to operate in either standalone mode or with the IRC-6, while the slave products will be set to operate in slave mode. Once set and connected, the slave products will operate in unison with the master product.

Configure the products as indicated below.

Slave products:

1. Press **<MENU>** repeatedly until **3Ch** shows on the display.
2. Press **<ENTER>**.
3. Use **<UP>** or **<DOWN>** to set the starting address to **d001**.
4. Press **<ENTER>**.
5. Connect the DMX input of the first slave product to the DMX output of the master product.
6. Connect the DMX input of the subsequent slave products to the DMX output of the previous slave product.
7. Finish setting and connecting all the slave products.

Master product:

1. Set the master product to operate in standalone mode.
2. Make the master product the first product in the DMX daisy chain.



- **Configure all the slave products before connecting the master to the daisy chain.**
- **Never connect a DMX controller to a DMX string configured for Master/Slave operation because the controller may interfere with the signals from the master.**
- **Do not connect more than 31 slaves to the master.**

D-Fi USB Master/Slave Mode

The D-Fi USB allows a single EVE F-160ZQ product (the “master”) to control the actions of one or more EVE F-160ZQ products (the “slaves”) without the need of a DMX controller or DMX cables. The master (transmitter) product will be set to operate in standalone mode, while the slave (receiver) products will be set to operate in slave mode. Once set and connected, the slave products will operate in unison with the master product.

Configure the products as indicated below.

Slave products:

1. Press **<MENU>** repeatedly until **3Ch** shows on the display.
2. Press **<ENTER>**.
3. Use **<UP>** or **<DOWN>** to set the starting address to **d 1**.
4. Press **<ENTER>**.
5. Set the D-Fi USB to receive on a specific channel, 1–16.
6. Plug in the D-Fi USB.
7. Finish setting and connecting all the slave products.

Master product:

1. Set the master product to operate in standalone mode.
2. Set the D-Fi USB to transmit on the D-Fi channel the slaves are receiving on.
3. Plug in the D-Fi USB.



- **All products must be set to the same DMX personality, DMX address, and D-Fi channel.**
- **Configure all the slave products before configuring the master to transmit.**
- **Never connect a DMX controller to a D-Fi channel configured for Master/Slave operation because the controller may interfere with the signals from the master.**

5. Maintenance

Product Maintenance

Dust build-up reduces light output performance and can cause overheating. This can lead to reduction of the light source's life and/or mechanical wear. To maintain optimum performance and minimize wear, clean all lighting products at least twice a month. However, be aware that usage and environmental conditions could be contributing factors to increase the cleaning frequency.

To clean the product, follow the instructions below:

1. Unplug the product from power.
2. Wait until the product is at room temperature.
3. Use a vacuum (or dry compressed air) and a soft brush to remove dust collected on the external surface/vents.
4. Clean all transparent surfaces with a mild soap solution, ammonia-free glass cleaner, or isopropyl alcohol.
5. Apply the solution directly to a soft, lint free cotton cloth or a lens cleaning tissue.
6. Softly drag any dirt or grime to the outside of the transparent surface.
7. Gently polish the transparent surfaces until they are free of haze and lint.



Always dry the transparent surfaces carefully after cleaning them.



Do not spin the cooling fans using compressed air because they could be damaged.

6. Technical Specifications

Dimensions and Weight

Length	Width	Height	Weight
15 in (380 mm)	8.9 in (227 mm)	14 in (357 mm)	10.2 lb (4.6 kg)

Note: Dimensions in inches are rounded.

Power

Power Supply Type	Range	Voltage Selection
Switching (internal)	100 to 240 VAC, 50/60 Hz	Auto-ranging

Parameter	120 V, 60 Hz	230 V, 50 Hz
Consumption	163 W	159 W
Operating Current	1.4 A	0.7 A
Power linking current (products)	12 A (9 products)	12 A (16 products)
Fuse	3.15 A, 250 V	3.15 A, 250 V

Power I/O	U.S./Worldwide	UK/Europe
Power input connector	powerCON® compatible	powerCON® compatible
Power output connector	powerCON® compatible	powerCON® compatible
Power cable plug	Edison (U.S.)	Bare wire

Light Source

Type	Color	Quantity	Power	Current	Lifespan
LED	Quad RGBW	1	160 W	7.3 A	50,000 hours

Photometrics

Strobe Rate	Color Temperature	Beam Angle	Field Angle	PWM Frequency	Lumens	CRI
0 to 30 Hz	2800K–8000K	16° to 61°	29° to 90°	1200 Hz	3219	96

Illuminance @ 2m (16°)	Illuminance @ 2m (61°)	Illuminance @ 5m (16°)	Illuminance @ 5m (61°)
5975	733	956	117

Thermal

Maximum External Temperature	Cooling System
104 °F (40 °C)	Convection

DMX

I/O Connector	Channel Range
3-pin and 5-pin XLR	3, 4, or 11 Ch

Ordering

Product Name	Item Code	UPC Number
EVE F-160ZQ	03052334	781462226824

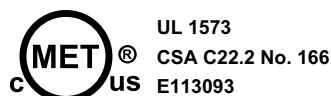

Contact Us

General Information	Technical Support
Chauvet World Headquarters	
Address: 3360 Davie Rd., Suite 509 Davie, FL 33314 Voice: (954) 577-4455 Fax: (954) 929-5560 Toll Free: (800) 762-1084	Voice: (844) 393-7575 Fax: (954) 756-8015 Email: chauvetcs@chauvetlighting.com Website: www.chauvetdj.com
Chauvet U.K.	
Address: Pod 1 EVO Park Little Oak Drive, Sherwood Park Nottinghamshire, NG15 0EB UK Voice: +44 (0) 1773 511115 Fax: +44 (0) 1773 511110	Email: UKtech@chauvetlighting.eu Website: www.chauvetdj.eu
Chauvet Benelux	
Address: Stokstraat 18 9770 Kruishoutem Belgium Voice: +32 9 388 93 97	Email: BNLtech@chauvetlighting.eu Website: www.chauvetdj.eu
Chauvet France	
Address: 3, Rue Ampère 91380 Chilly-Mazarin France Voice: +33 1 78 85 33 59	Email: FRtech@chauvetlighting.fr Website: www.chauvetdj.eu
Chauvet Germany	
Address: Bruno-Bürgel-Str. 11 28759 Bremen Germany Voice: +49 421 62 60 20	Email: DEtech@chauvetlighting.de Website: www.chauvetdj.eu
Chauvet Mexico	
Address: Av. de las Partidas 34 - 3B (Entrance by Calle 2) Zona Industrial Lerma Lerma, Edo. de México, CP 52000 Voice: +52 (728) 690-2010	Email: servicio@chauvet.com.mx Website: www.chauvetdj.mx

Warranty & Returns

For warranty terms and conditions and return information, please visit our website.

For customers in the United States and Mexico: www.chauvetlighting.com/warranty-registration.

For customers in the United Kingdom, Republic of Ireland, Belgium, the Netherlands, Luxembourg, France, and Germany: www.chauvetlighting.eu/warranty-registration.